

- Circuito inversor com capacidade de 5A
- Mecanismo de ação rápida com mola helicoidal de longa vida
- Ação de rolagem e autolimpeza dos contatos
- Variedade de atuadores e configuração de contatos
- Terminais faston, solda e para circuito impresso
- Dimensões conforme DIN 41635 forma B
- Componente Reconhecido UL (File E212007)

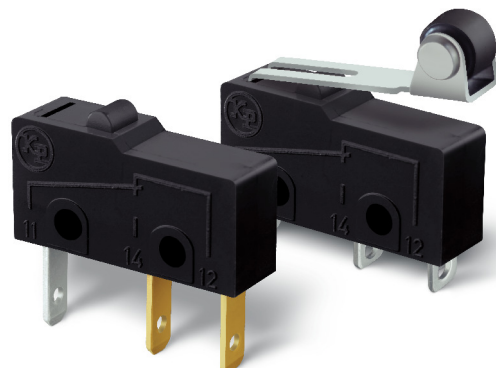

### Capacidade Elétrica

5A em 250Vca

### Esquemas Elétricos (IEC 60947-5-1)

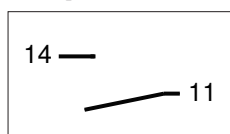

Forma A (NA)

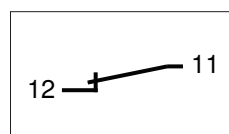

Forma B (NF)

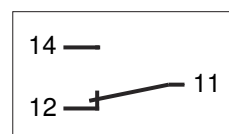

Forma C (NA+NF)

### Especificações

Resistência de Contato	50 mΩ máximo inicial (em 1A 5Vcc)	
Temperatura Ambiente	+85°C máximo	
Grau de Proteção	IP40 (IEC 60529)	
Velocidade de Operação	0,5 mm/s mínimo a 1 m/s máximo (no atuador de Pino)	
Vida Mecânica	10.000.000 ciclos	
Vida Elétrica	50.000 ciclos (em 5A 250Vca)	
Materiais	Invólucro:	Poliamida
	Botão:	Poliamida
	Atuadores:	Alavanca: Aço Inox (tipos E, R e U)      Latão niquelado (tipos D, G e J) Rolete: Poliamida
	Terminais:	Latão
Contatos:	Liga de Prata	

## Dimensões Básicas

Dimensões em mm

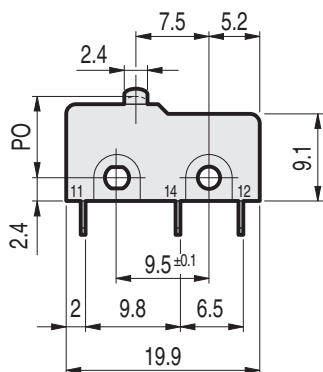

Modelo básico - Atuador de Pino com Terminal para solda

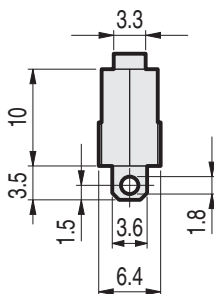

Terminal Faston 2,8 X 0,5 (Quick Connect 0,110")

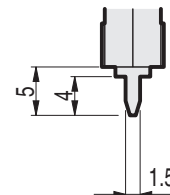
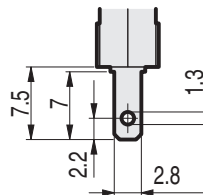

Terminal para Circuito Impresso

Microrrutor com 3 terminais.  
Configuração normal dos contatos:  
11 = Comum (COM)  
12 = Normalmente Fechado (NF)  
14 = Normalmente Aberto (NA)

## Fixação

Dimensões em mm

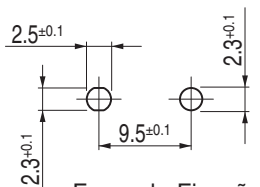

Furos de Fixação da Caixa

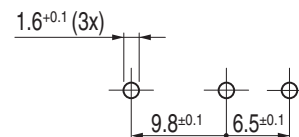

Furos para Placa de Circuito Impresso

## Atuadores Incorporados

Dimensões em mm

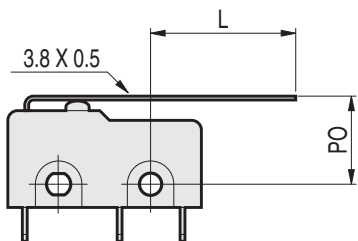

Alavanca plana (Tipo E)

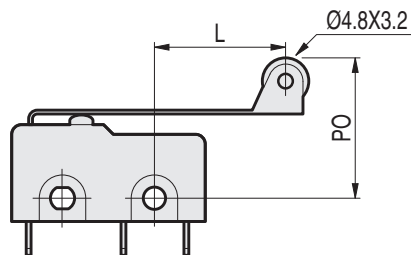

Alavanca com rolete (Tipo R)

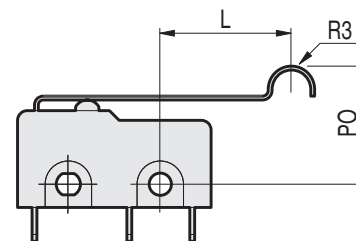

Alavanca c/rolete simulado (Tipo U)

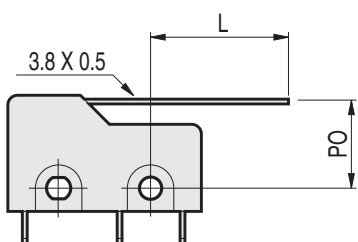

Alavanca plana (Tipo G)

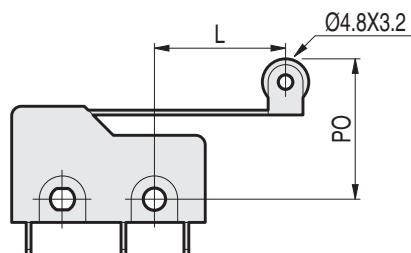

Alavanca com rolete (Tipo J)

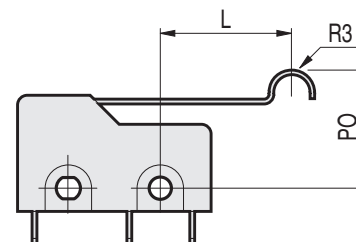













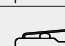
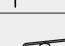



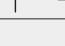

Alavanca c/rolete simulado (Tipo D)



Sujeito a alteração sem informação prévia

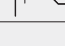

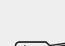
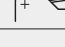
## Código para Compra

**M M 1 G 3 N S**

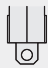
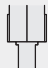
Aplicação	
Força no Botão	Código
100 gf	= MM2
200 gf	= MM1 ①

Atuador		
Forma		Código
Atuador de Pino		= A ①
Alavanca plana curta		= E1 ①
		= E2
Alavanca plana		= E3
		= E4
Alavanca curta c/rolete		= R1 ①
Alavanca c/rolete		= R3
Alavanca curta c/rolete simulado		= U1
Alavanca c/rolete simulado		= U3
Alavanca plana curta		= G1
		= G2
Alavanca plana		= G3
		= G4
Alavanca curta c/rolete		= J1
		= J2
Alavanca c/rolete		= J3
		= J4
Alavanca curta c/rolete simulado		= D1
		= D2
Alavanca c/rolete simulado		= D3
		= D4

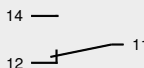
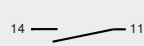
Terminais		
Tipo	Forma	Código
para Solda		= S ①
Faston		= F
Circuito Impr.		= I

Configuração dos Contatos		
NA + NF		= N ①
só NA (Normalmente Aberto)		= N1
só NF (Normalmente Fechado)		= N2

### Nota:

① Modelos disponíveis em estoque. Os demais são disponíveis sob consulta prévia.

## Aplicações Especiais

Além dos produtos apresentados neste catálogo, que são os de comercialização prevista, podemos desenvolver modelos "personalizados" para aplicações especiais. Contate-nos para:







- Invólucro UL94 V-0 ou para 120°C
- Atuadores com formas especiais

Sujeito a alteração sem informação prévia

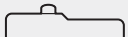
### Características

**Terminologia:** FO .... Força de Operação  
PO ... Ponto de Operação  
PI ..... Percurso Inicial

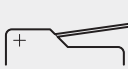
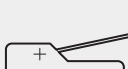
PD ... Percurso Diferencial  
PS ... Percurso Suplementar  
L ..... Comprimento do Atuador

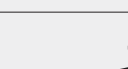
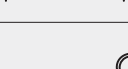
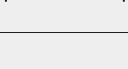
Atuador		FO (gf)		PO (mm)	PI máx (mm)	PD máx (mm)	PS mín (mm)	L (mm)
		MM1	MM2					
	A	200	125	8.4 ± 0.4	0.8	0.15	0.4	-
	E1	56	34	8.9 ± 1.5	2.9	0.5	0.8	5.2 ± 0.4
	E2	43	26	8.9 ± 2.0	3.7	0.7	1.1	10.4 ± 0.4
	E3	37	23	8.9 ± 2.3	4.4	0.8	1.3	14.4 ± 0.4
	E4	33	20	8.9 ± 2.6	4.9	0.9	1.4	17.6 ± 0.4
	R1	55	34	14.4 ± 1.6	2.9	0.5	0.8	5.4 ± 0.6
	R3	39	24	14.4 ± 2.2	4.1	0.8	1.2	12.6 ± 0.6
	U1	52	33	11.9 ± 1.7	3.1	0.6	0.9	6.4 ± 0.6
	U3	38	24	11.9 ± 2.3	4.2	0.8	1.2	13.6 ± 0.6
	G1	53	33	8.9 ± 1.6	3.0	0.6	0.6	7.2 ± 0.5
	G3	39	24	8.9 ± 2.2	4.1	0.8	0.8	14.4 ± 0.5
	G2	21	13	8.9 ± 2.0	7.6	1.4	0.1	10.4 ± 0.5
	G4	15	10	8.9 ± 2.7	10.4	1.9	0.15	17.6 ± 0.5
	J1	58	36	14.4 ± 1.6	2.8	0.5	0.6	5.4 ± 0.6
	J3	42	26	14.4 ± 2.1	3.8	0.7	0.8	12.6 ± 0.6
	J2	23	14	14.4 ± 1.9	6.9	1.3	0.1	8.6 ± 0.6
	J4	16	10	14.4 ± 2.6	9.7	1.8	0.1	15.8 ± 0.6
	D1	55	34	11.9 ± 1.6	2.9	0.5	0.6	6.4 ± 0.6
	D3	40	25	11.9 ± 2.1	4.0	0.8	0.8	13.6 ± 0.6
	D2	22	14	11.9 ± 2.0	7.3	1.4	0.1	9.6 ± 0.6
	D4	16	10	11.9 ± 2.7	10.1	1.9	0.1	16.8 ± 0.6

Sujeito a alteração sem informação prévia